



# Chalet Valhalla

Collineige

+44 (0)1483 579242

[sales@collineige.com](mailto:sales@collineige.com)

[www.collineige.com](http://www.collineige.com)

[skype: collineigesales.uk](skype:collineigesales.uk)



7 Bedrooms

6 Bathrooms

Jacuzzi Hot Tub

Parking

Garden

5 minutes walk to  
Chamonix centre

*Light and airy  
Scandinavian  
chic, with floor to  
ceiling views of  
Mont Blanc.*

## NAVIGATION

[Overview](#)

[Interior](#)

[Layout](#)

[Service](#)

[Location](#)



Chalet Valhalla was built with beautiful, natural timbers and is a structure of grand proportions right in the heart of Chamonix.

It is open and light with floor to ceiling windows giving you Titanic views of Mont Blanc. A minstrel's gallery overlooks the sitting/dining room and from here you share the same breathtaking view that is enjoyed from below.

## NAVIGATION

[Overview](#)

[Interior](#)

[Layout](#)

[Service](#)

[Location](#)

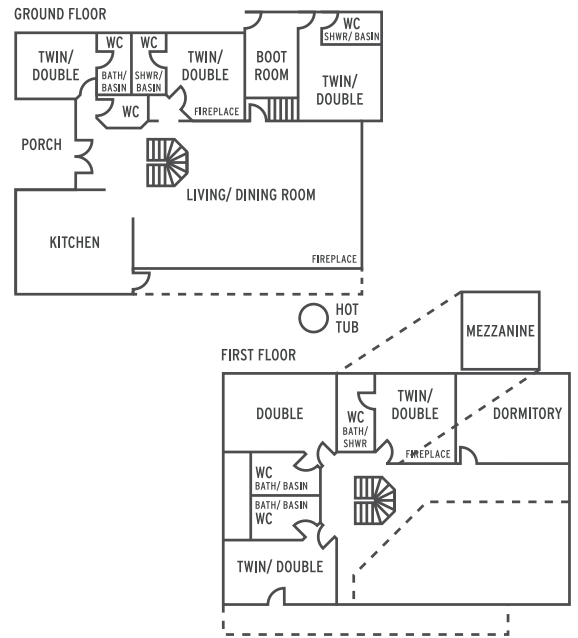

There are three double/ twin bedrooms on the ground floor, all with en suite bath/ shower rooms and a cloakroom. On the first floor there is one double room and two double/ twin rooms, one of which has a mezzanine floor with mattresses where one or two children can sleep. There is also a large dormitory bedroom with up to four beds.



250 sq metres

Sky TV

Wifi

Log fire

Wood burning stoves

Parking

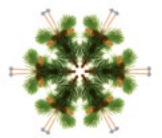

NAVIGATION

Overview

Interior

Layout

Service

Location



We normally offer the chalet on a self catered basis in the summer. This includes:

- ❄️ Egyptian cotton linen and towels
- ❄️ L'Occitane toiletries
- ❄️ Representative service
- ❄️ A welcome pack of food and kitchen essentials
- ❄️ A final clean at the end of your stay



However we can also offer the chalet with extra services such as:

- ❄️ Breakfast
- ❄️ Housekeeping
- ❄️ Private chef
- ❄️ Transfers
- ❄️ Driver



## NAVIGATION

[Overview](#)

[Interior](#)

[Layout](#)

[Service](#)

[Location](#)

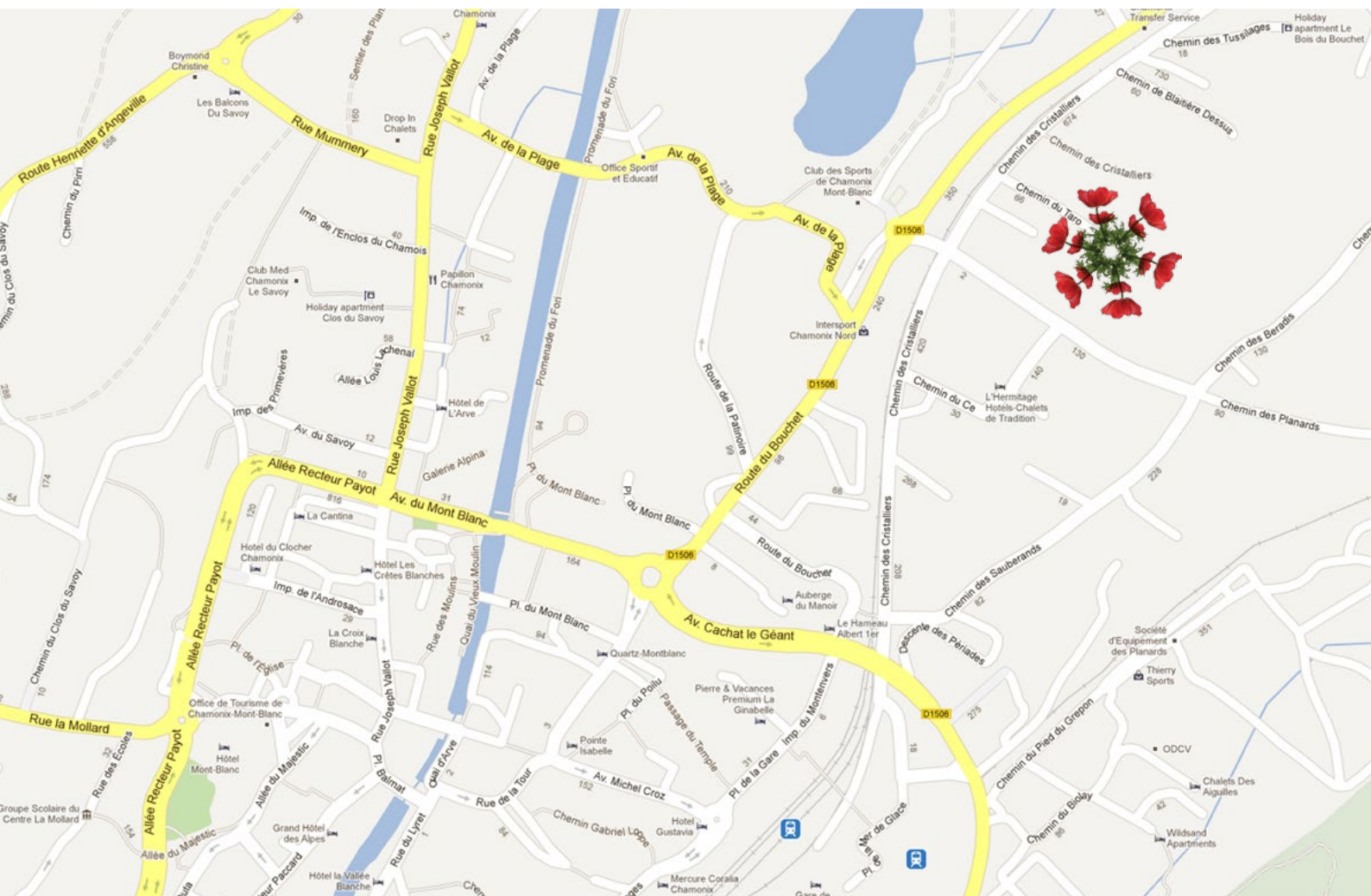

Collineige +44 (0)1483 579242 sales@collineige.com www.collineige.com skype: collineigesales.uk

Valhalla's location hits the high notes, set in an idyllic spot beside the forest it is also only a short stroll to the centre.

More importantly it is a mere two minutes staggering distance from the popular MBC bar and the Michelin starred Albert 1er is just around the corner. Perfect!

## NAVIGATION

Overview

Interior

Layout

Service

Location